

# Franke Semi Pro Vario Spray Tap

## Replacing Cartridge & O-Rings

### Replacing the cartridge

Before replacing the cartridge, you will need to turn the water off. You will need to remove the screw cover (1) by prising it off. Once this is removed, you'll be able to remove the handle retaining screw (2) with a 3mm allen key. This will then allow you to remove the handle (3). You'll then be able to unscrew the cartridge cover (4) by unscrewing it anticlockwise. You can then remove the cartridge locking ring (5) by using an adjustable spanner. You will then be able to remove the existing cartridge (6) and replace with the new part.

### Replacing the o rings

To replace the o rings, you will first need to remove the hose. To do this, unscrew the hose from underneath the tap and pull through from the end of the spout.

You will need to remove the spout retaining screw (7) by using a 3mm allen key. You will then be able to lift the spout (8) up and replace the o rings (9) at the base with the new parts.

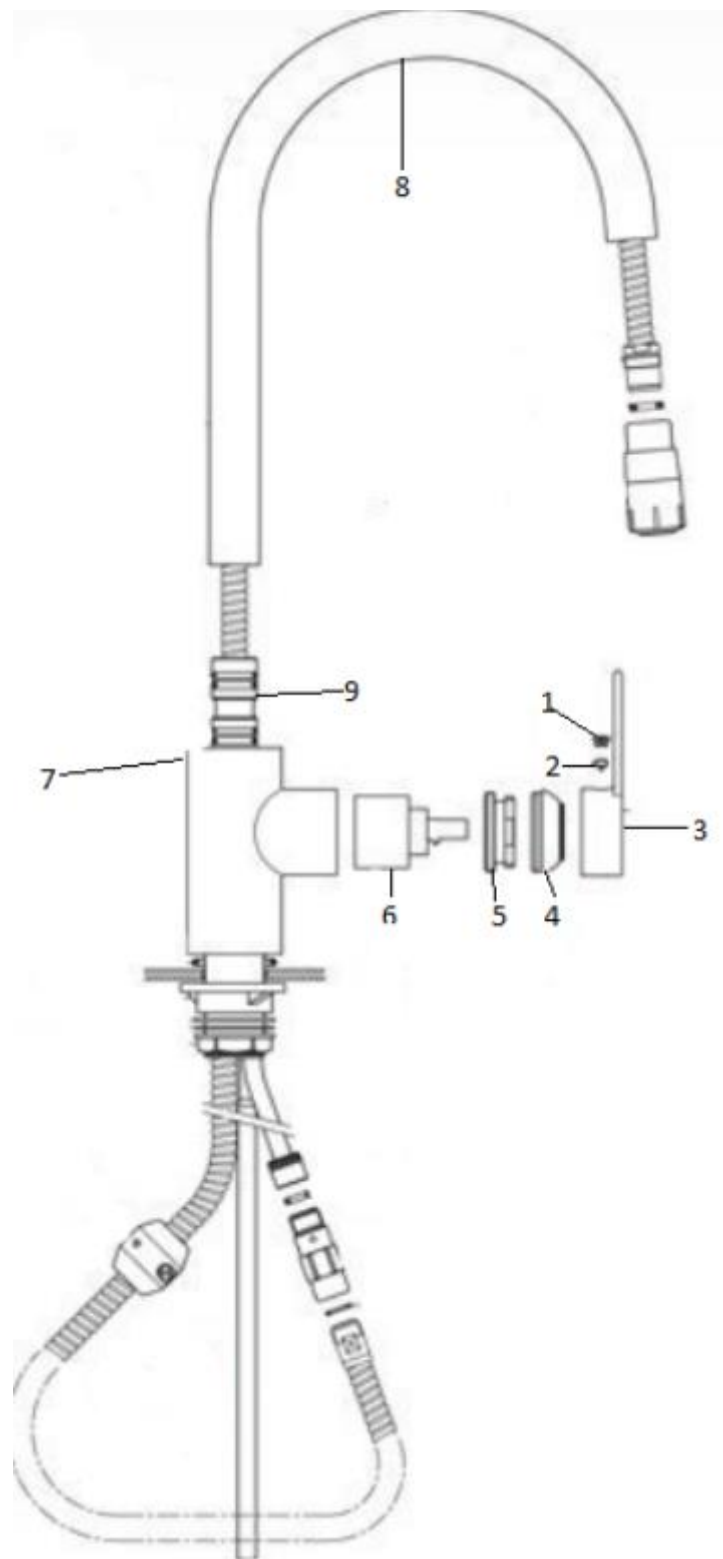

Central Services Ltd  
Unit 17 Park Hall Business Village  
Park Hall Road  
Stoke-on-Trent  
ST3 5XA

01782 599258  
[ks-ukcentralservices.gb@franke.com](mailto:ks-ukcentralservices.gb@franke.com)

*Make  
it  
Wonderful*

**FRANKE**